

Proposal to enhance wildlife habitat and support bees and other insects at the heart of Freshford village
Friends of Freshford. October 2020

The intention of this plan is to outline a beginning of ongoing changes to address the serious decline of bees and the loss of biodiversity and as part of a wider response to the climate and ecological emergency.



The Tying, War Memorial and cemetery

KEY

- ① Plant native bulbs & / or wildflowers
- ② Hedgerow (plant or restore)
- ③ Native tree planting (small & medium size)
- ④ Community Orchard
- ⑤ Flower meadow mix (war memorial)
- ⑥ Roadside border hump (native bulbs & wildflowers)
- ⑦ cemetery (details to follow)
- ⑧ Memorial trees (native species)
- ⑨ Majestic trees (oak / walnut?)
- ⑩ Willow & Alder (wet tolerant species)

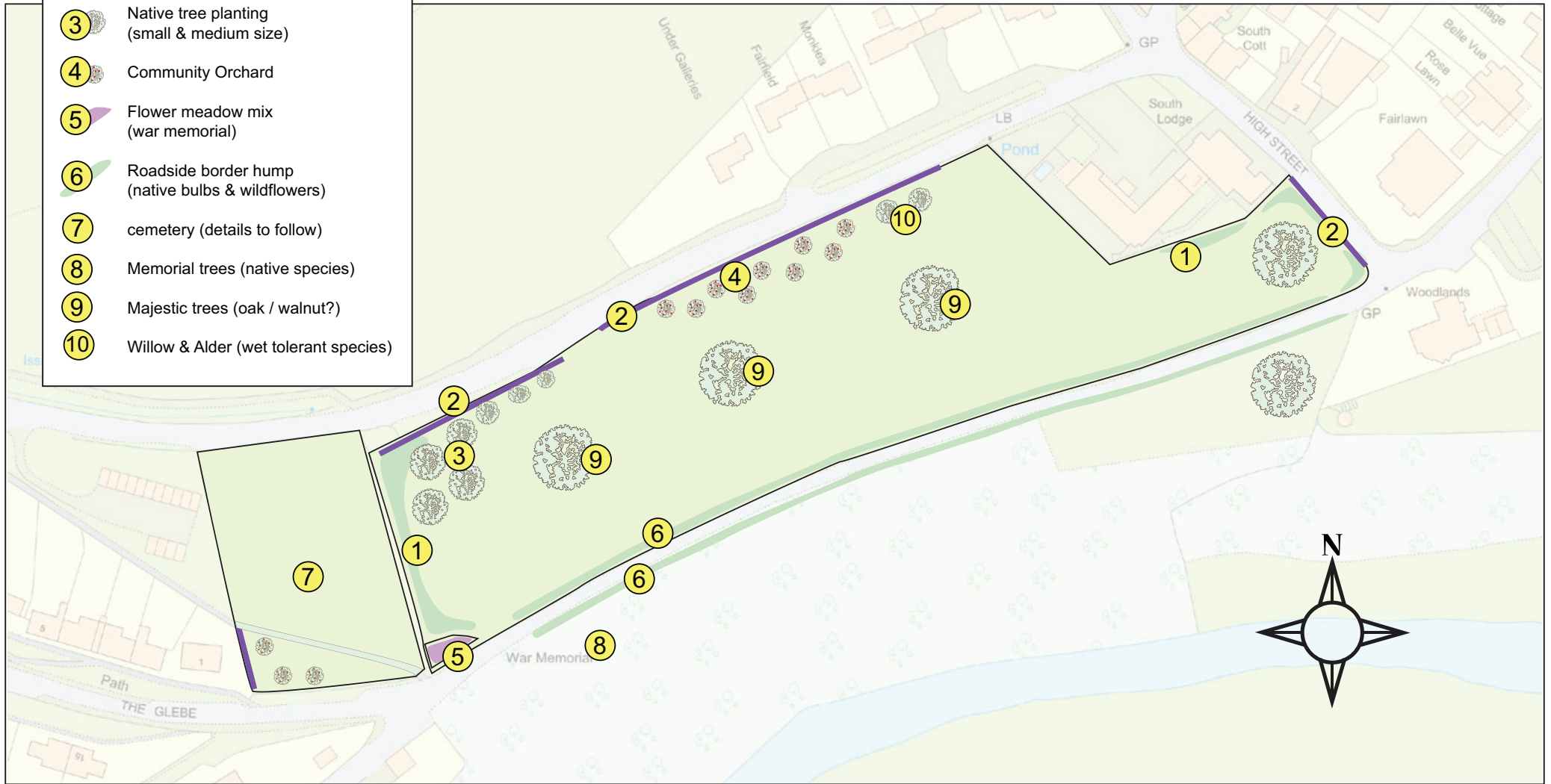

Bulb planting
Sowing wild flower seeds
Wild flower plug plants

Shady areas under the trees will be most suited to bluebells and wood anemones whilst the raised edges of Tynning Lane can be host to native daffodils, lesser celandine etc.

The wholesale price of bulbs is likely to be around £150 - £200 per 1000. For an area as large as the Tynning we need to be thinking in thousands rather than hundreds.

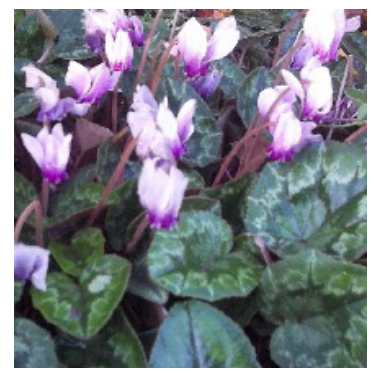

Roadside humped border Tynning Lane



The hump of earth and grasses that runs alongside the edge of Tynning Lane offers a habitat for wild flowers and grasses and at the same time appears to discourage cars from driving over the grass. By duplicating this on the other side of the lane (leaving, of course, the passing place) there may be no need for wooden bollards to prevent driving and parking on the grass. Both humps can be planted up with *native* bulbs and *native* perennial wild flower and grass seeds. A mown strip to the side of the hump could provide a footpath if needed and breaks in the hump allow pedestrians to step easily out of the road.

It may be possible to source subsoil from building excavations and low fertility soil can be purchased. This may be a job best suited to the spring as it is becoming increasingly wet and muddy in the autumn. Bulbs can, in the mean time, be planted on the existing hump.



LOW FERTILITY SOIL

CALCULATE SHIPPING

£74.99 (£89.99 INC VAT)

- Bag Size: 700 litres
- Screened to: 10mm
- Typical PH: Between 7.0 & 8.0
- BS Certification: BS3882:2015 'Low Fertility Specification'

Delivery charges (if applicable) are calculated at the basket stage and are based on your delivery postcode. You can see these charges prior to confirming your order and entering your payment details.

ADD TO BASKET

Above the school

- Hedgerow planting along the High Street field edge
- Native bulbs and wild flowers around the edges
- Nesting boxes in the oak



The war memorial

The small area around the war memorial can be stripped of turf, and sown with a suitable seed mix (including poppies) to provide nectar and habitat for bees and other insects as well as a beautiful display throughout the summer and early autumn.

Friends of Freshford would be happy to sponsor this project and to carry out the work this month (October 2020).



Suggested bee-friendly floral mix including poppies, for 3 months of colourful display:

25 annual & perennial species including *Agrostemma githago*, *Ammi majus*, *Centaurea cyanus*, *Chrysanthemum leucanthemum*, *Chrysanthemum segetum*, *Coreopsis lanceolata*, *Gypsophila elegans*, *Lathyrus odoratus*, *Linum perenne*, *Lupinus perennis*, *Papaver rhoeas* and *Salvia horminum*

Large trees

The celebratory planting of three major trees (such as oak, walnut and lime) on the Tynning area would mark our commitment to nature, particularly in light of the significant losses of ash trees that are expected in the near future.



Freedom Hive, Nesting boxes, Hedgehog habitat etc

The Freedom hive is inspired by traditional log hives but weighing only 17kgs, can be hoisted easily into trees or put on a tripod stand.

The hive body is a 12 sided cylinder with a volume of 55 litres. It is not intended for the harvesting of honey but as safe and natural habitat for bees.

The sides of the hives are comprised of three layers: wood/compressed shavings/wood to give thick warm insulation with an inspection board on the base and a thick cedar board on the top from which the bees will build their comb downwards.

<https://beekindhives.uk/the-freedom-hive-2/>



Community involvement

There are many ways in which to engage all ages and groups in nature projects on the Tynning and beyond.

Positive publicity and signage

Volunteer Days

Apple Day

Festival of wild flowers, bees and trees

School wildlife learning opportunities

Sponsor a Tree (each group within the village could sponsor a tree (Brownies, WI, Horticultural soc., Freshford Primary School, Football club etc.)

Memorial trees



Community Orchard

We see the proposed community orchard utilizing a portion of the flat, lower part of Tying Field. A small orchard is envisaged comprising local apple varieties alongside plum and damson trees. These trees would provide much needed pollen and nectar for bees early in the spring, and fruit for wild birds and the community to harvest throughout the summer and autumn. The planting and care of the trees could be a community project, involvement of the school children would be welcomed, and the harvesting of the fruit each autumn would naturally coincide with the annual village Apple Day.

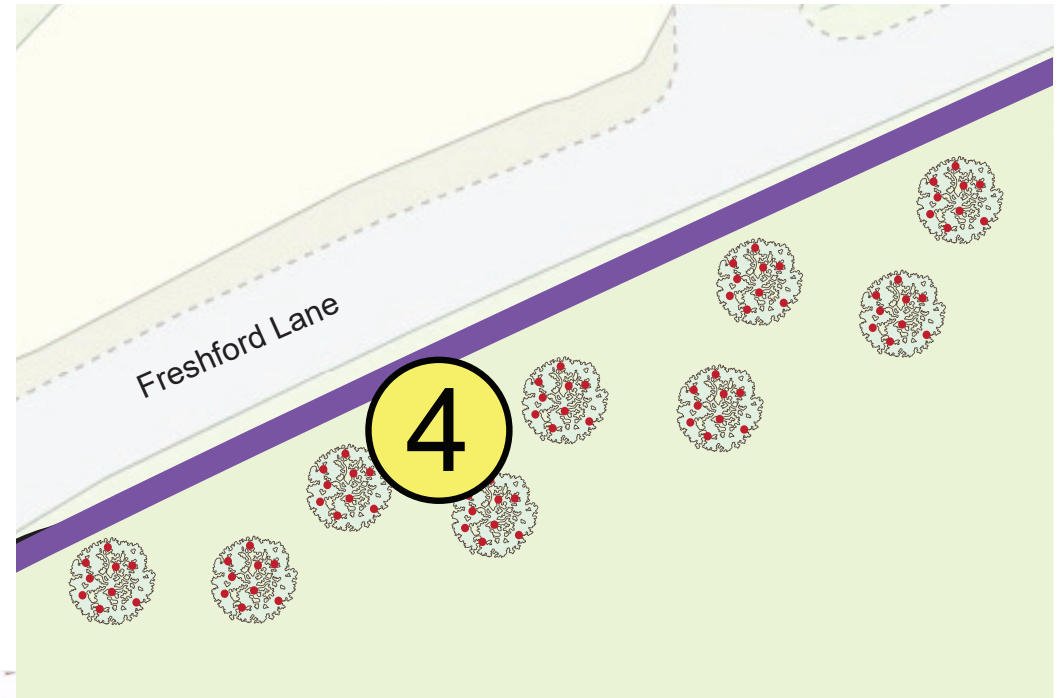

<https://www.kentdowns.org.uk/our-projects/orchards-for-everyone/>



<http://www.commoncause.org.uk/ringmer-community-orchard>

Freshford Cemetery

Plans for the cemetery will include removal of ash saplings from old graves; allowing the grass to grow and observing the existing diversity; mowing wide flowing paths for access; sowing bee-friendly annual flower seeds, bulbs and native perennials and above the path a seating area, hedgerow planting between the wall and the path on the west boundary and some nut trees (hazel, filbert, almond).

