

# Planning Report - 20/01574/FUL Freshford Mill Solar Panel Application

The Freshford Mill site sits within the Freshford and Sharpstone Conservation area and AONB.

The application is for the erection of x 6 ground mounted black PV solar panels and would be sited behind the garage block which serves Rackham Court. The idea is that they will improve the sustainability credentials of this particular block. A screenshot of the plan has been included below with the solar panel area marked with a red line. I believe that each panel is just under 2 meters in width and just over a meter in height although this is not exactly clear on the application.

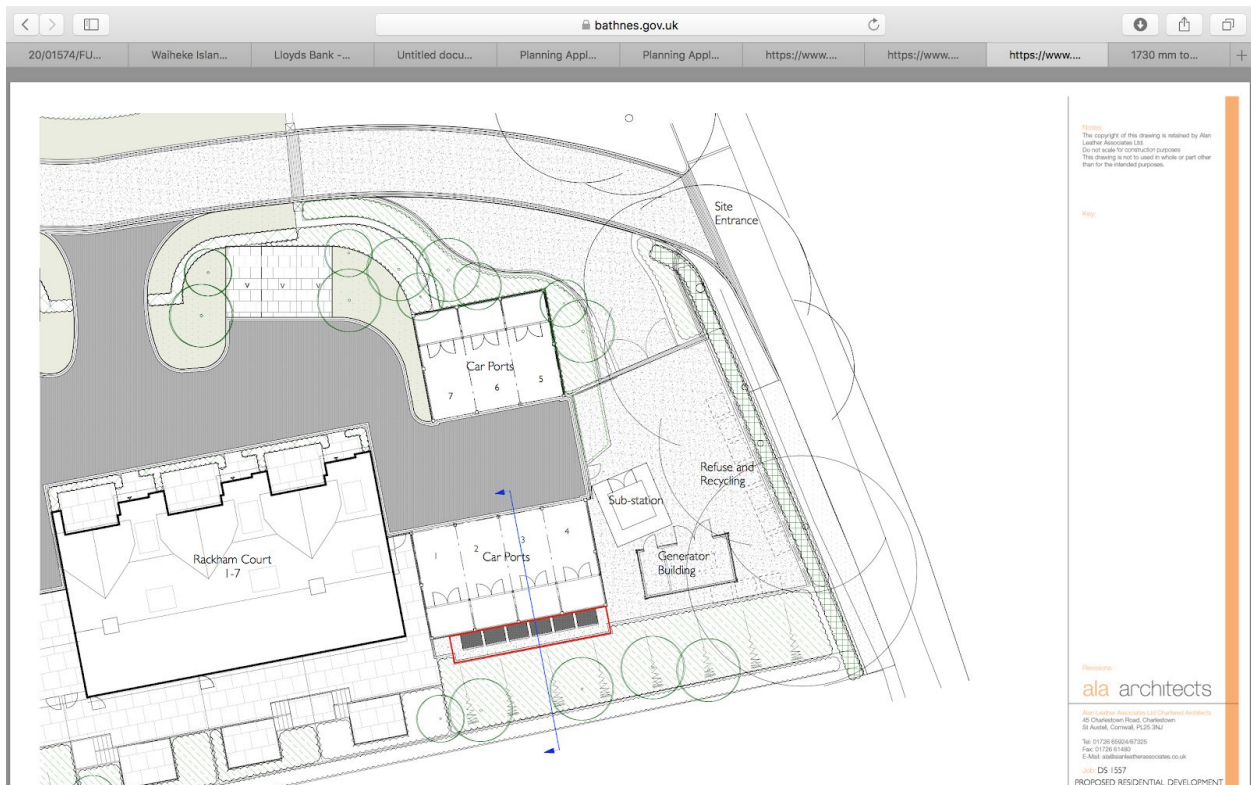

It's worth noting that the panels will have minimal if any visual impact in the applied for location as they are tucked behind the garage block but also have trees to the rear. The latter may in time have an effect on how productive the solar panels are given that the trees will grow and may produce shading thus making the panels less effective.

The below points have been taken from the planning portal in reference to solar panel applications.

- Only the first stand alone solar installation will be permitted development. Further installations will require planning permission.
- No part of the installation should be higher than four metres
- The installation should be at least 5m from the boundary of the property
- The size of the array should be no more than 9 square metres or 3m wide by 3m deep
- Panels should not be installed within boundary of a listed building or a scheduled monument.
- if your property is in a conservation area, or in a World Heritage Site, no part of the solar installation should be nearer to any highway bounding the house than the part of the house that is nearest to that highway.

I believe that the above points will be taken into account by the planning officer.

Taking all of the above points into account I do feel that FPC should support this application given that it is a positive step towards improving sustainability in reducing carbon emissions for housing. It is also in line with BANES's and the FPC'S declaration of a climate emergency.